

P.C.B LAYOUT

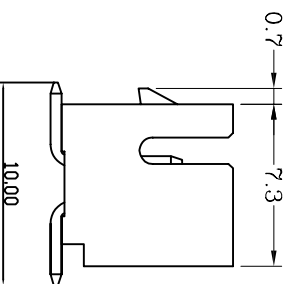
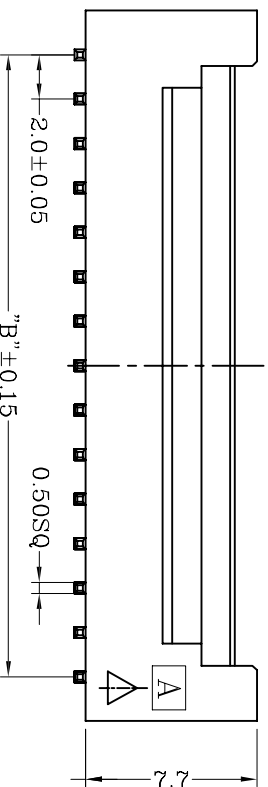

	2x4P	2x5P	2x6P	2x7P	2x8P	2x9P	2x10P	2x11P	2x12P	2x13P	2x14P	2x15P	2x16P	2x17P	2x18P	2x19P	2x20P	2x30P
A	10.0	12.0	14.0	16.0	18.0	20.0	22.0	24.0	26.0	28.0	30.0	32.0	34.0	36.0	38.0	40.0	42.0	62.0
B	6.0	8.0	10.0	12.0	14.0	16.0	18.0	20.0	22.0	24.0	26.0	28.0	30.0	32.0	34.0	36.0	38.0	58.0

ROHS COMPLIANT

技术参数 SPECIFICATIONS

- ◆ 额定电压：250V DC/AC
Rated voltage: 250V DC/AC
- ◆ 额定电流：3A DC/AC
Rated Current: 3A DC/AC
- ◆ 耐压值：1000V AC/minute
Withstand voltage: 1000V AC/minute
- ◆ 工作温度：-25° C ~ +85° C
Working Temperature: -25° C ~ +85° C
- ◆ 绝缘电阻：≥ 1000 MΩ
Insulation resistance: ≥ 1000 MΩ
- ◆ 接触电阻：□ 30mΩ
Contact resistance: □ 30μΩ
- 材料 MATERIAL
- ◆ 塑胶：尼龙9T (Nylon9T)，UL94V-0
- ◆ PIN针：黄铜 (Brass)

Ordering Information

WFLDSV3 - XX XX 001 X

No. of Pins Per Row: 4-30P

Standard Plating: 01=Gold Flash, 02=Gold 3U", 11=Fin, XY=Select Plating

Packing: T=Tube, TP=Tape Reel

GENERAL TOLERANCE	ANGLE TOLERANCE	DESIGN	DATE	ELETE TECHNOLOGY CO., LTD 億沐得股份有限公司	FILE NAME (品名)	2.0MM Wafer Double SMT Type
X, X, XX, .XXX	X., X', .XXX	±, ±0.38, ±0.25, ±0.13	±5°, ±2', ±1"			
UNIT:mm	SCALE 1:1	CHECK	DATE		DRAWING NO(图号)	WFLDSV3-01
A4	SHEET: 1 of 1	APPRO.	DATE			REV:AO